

# TRANSMISSION

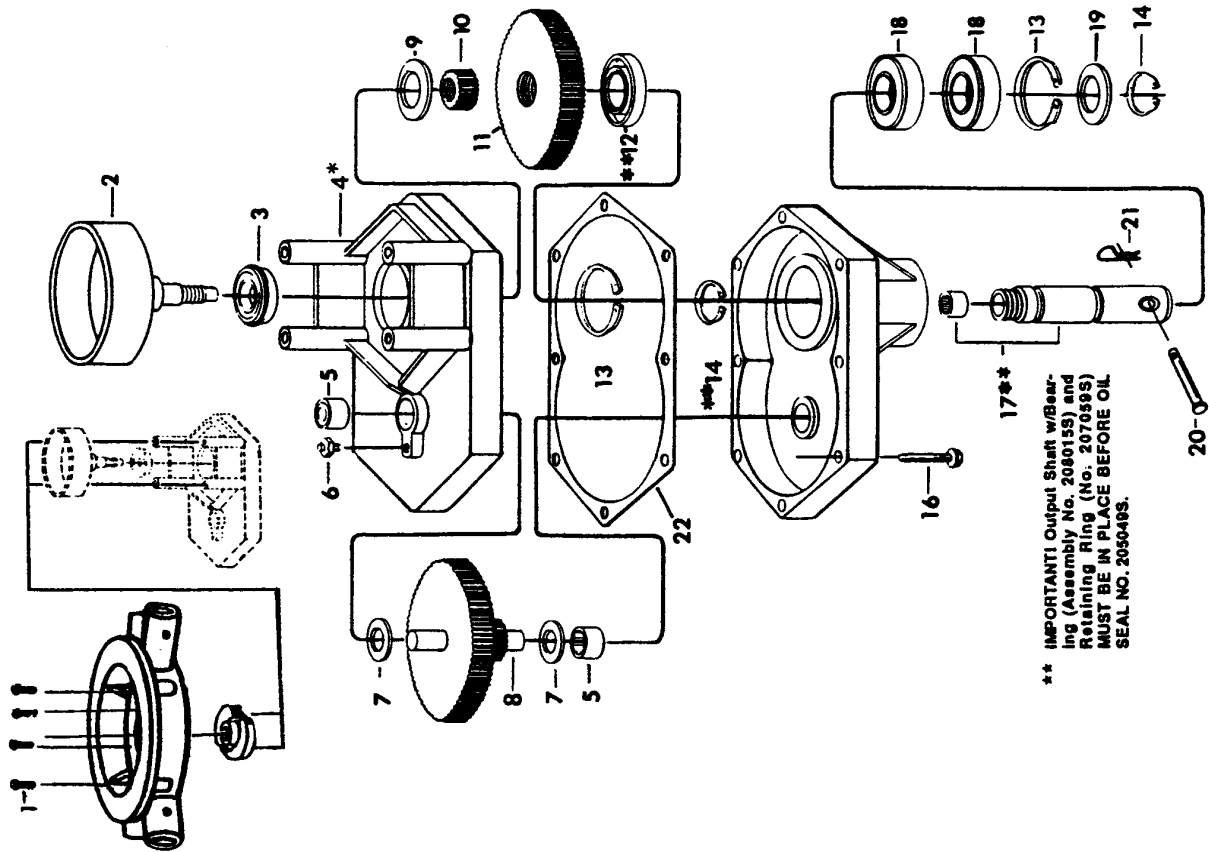

\*\* IMPORTANT! Output Shaft w/Bearing (Assembly No. 208015S) and Retaining Ring (No. 207059S) MUST BE IN PLACE BEFORE OIL SEAL NO. 205049S.

## Transmission, Complete — Order No. 207271S

ITEM NO.	ORDER NO.	DESCRIPTION	QTY. REQ.
1	217915S	Screw 5/16-18 x 1" Bracket to Transmission	4
2	217820S	Drum and Shaft, Clutch	1
3	202010S	Bearing, Ball w/Retaining Ring 1 3/8 O.D.	1
*4	217819S	Housing, Upper, Includes Items 2,3 and 5	1
5	207269S	Bearing, Roller, 5/8 I.D.	2
6	206599S	Fill Plug, Vented	1
7	200834S	Washer, 16 Ga., 5/8 I.D., 1 1/16 O.D.	2
8	217813S	Gear, Intermediate	1
9	200673S	Washer, 16 Ga., 41/64 I.D., 1 5/8 O.D.	1
10	207791S	Gear, Pinion, 16T	1
11	217817S	Gear, Output	1
12	205049S	Seal, Oil	1
13	203862S	Ring, Retaining	1
14	207059S	Ring, Retaining	2
16	207062S	Bolt, Wiz-Loc 1/4-20 x 1 3/8	2
*17	208015S	Shaft, Output-Includes Roller Bearing No. 207796S	8
18	205070S	Bearing, Ball 1" I.D., 2" O.D.	1
19	201532S	Washer, 1 1/32 I.D., 1 5/8 O.D., 11Ga.	2
20	203616S	Pin, Clevis	1
21	108935	Pin, Cotter	1
22	208092S	Gasket	1

\*Upper and Lower Housing sold in assemblies.

\*Output Shaft sold only in assembly with Roller Bearing No. 207796S

**IMPORTANT**  
**REPLACEMENT PART ASSEMBLY INFORMATION**  
**WHEN REPLACING SCREWS: Use Loctite #262 or equivalent.**